



RANGER 3000
RANGER COUNT 3000
VALOR 7000

Ethernet Interface Instruction Manual

INTRODUCTION

This Ethernet interface kit is for use with the Ranger 3000, Ranger Count 3000 and Valor 7000 scales.

KIT CONTENTS

- Ethernet PC Board
- Screws (4)
- Instruction Manual
- Cable

INTERFACE INSTALLATION

Install the Ethernet Interface on the underside of the balance as shown.

1. Remove the red interface options cover.

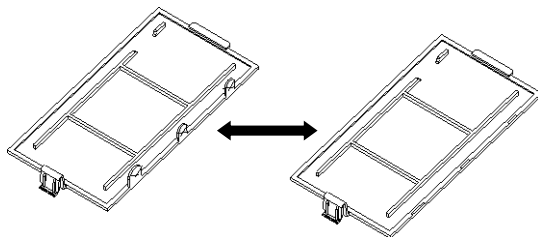

2. Install the Interface PCB. Push it through the pins and secure it with the 4 screws.

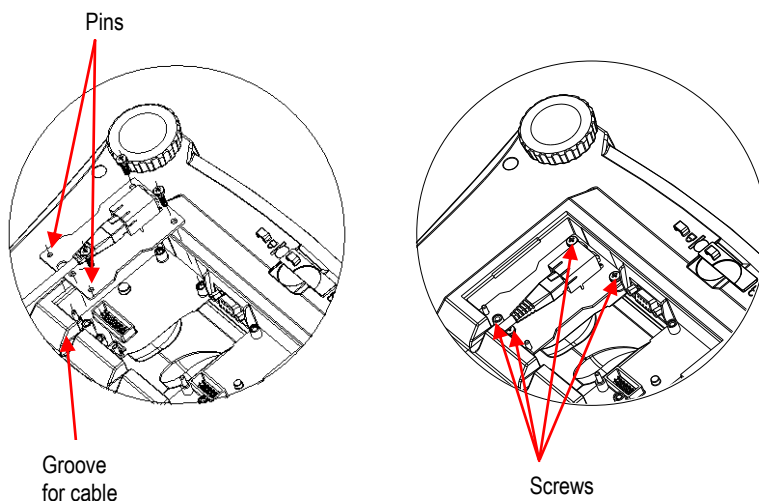

3. Connect an Ethernet Cable.

4. Place the cord in the groove (see step 2) and put the red interface option cover back on.

SETUP

Upon installation, the scale will recognize the Ethernet Interface Kit.

PRINT2	Ethernet
Reset	IP Addr
Stable Only	End
Off, On	
A.Print	
Off, On.stbl,	
Int, cont, Acc	
Content	
Layout	
Data.Tr	
End	

*Note: Print and Ethernet menu selections may vary between the different scale series.

Setup Definitions

PRINT / Stable Only - On	Transmits stable data only
PRINT / A.Print – On.Stbl	Automatically outputs data upon stability
PRINT / A.Print – On.Acc	Automatically outputs data in Accept Range
PRINT / A.Print – Cont	Repeatedly sends data as fast as possible
PRINT / A.Print – (xx) SEC	Sends data every (xx) seconds
PRINT / A.Print – OFF	Sends data when PRINT is pressed or P command
PRINT / Data.Tr – On	Transmits data
E.t.h.r.n.t / Ip Addr	Displays the scales IP Address

Ethernet Connection

The Interface has a preset IP Address which can be displayed by choosing **Ip Addr** in the menu. Use the “No” and “Back” keys to show the entire number on the display. The Port Number is **9761**.

OPERATION

Output

With the interface installed the scale will operate in one of the following two ways:

- Auto Print = off, Stable = on or off
Pressing PRINT will send the display data. If Stable is set to On, the balance will wait for a stable reading before sending data.
- Auto Print = not off, Stable = on or off
The scale will automatically send data based on the settings in the Menu. If Stable is set to On, only stable will be sent.

Data sent is in standard ASCII format terminated with a [CRLF] (carriage return-line feed).

[weight]	9 characters	
[space]	1 character	
[unit]	5 characters max (left justified)	
[space]	1 character	
[stability indicator]	1 character	“?” when unstable, blank when stable
[G/N]	1 character	
[LF]	1 character	

Input

The scale will respond to various commands sent via the interface.

IP	Immediate Print of displayed weight (stable or unstable).
P	Print displayed weight (stable or unstable).
CP	Continuous Print.
SP	Print on Stability.
xS	0S: Turn off "Stable Only" menu item and allow unstable print. 1S: Turn on "Stable Only" menu item and only print stable print.
xP	Interval Print x = Print Interval (1-3600 sec), 0P turns auto print OFF.
Z	Same as pressing Zero Key.
T	Same as pressing Tare Key.
xT	Download Tare value in grams (positive values only). Sending 0T clears tare (if allowed).
PU	Print current unit: g, kg, lb, oz, lb:oz, t, c (custom).
xU	Set scale to unit x: 1=g, 2=kg, 3=lb, 4=oz, 5=lb:oz, 6=t.
xM	Set scale to mode x. M will scroll to next enabled mode.
PV	Version: print name, software revision and LFT ON (if LFT is set ON).
H x "text"	Enter Header line, where x = line number 1 to 5, "text" = header text up to 24 alphanumeric characters.
F x "text"	Enter Footer line, where x = line number 1 to 2, "text" = rear text up to 24 alphanumeric characters.
\EscR	Global reset to reset all menu settings to the original factory defaults (Escape key + 'R' Key).

Auto-Print Operation

Once Auto-Print is activated in the menu, the balance will send data as required. To temporarily stop Auto-Printing, press the PRINT key. If there is data in the print buffer the printer will finish printing this data. A second press will resume Auto-Printing.

(Note: In some modes, stopping or resuming Auto-Print must be done when the balance is not reading "0".)

ACCESSORIES

For a complete listing of OHAUS printers and other accessories, contact OHAUS Corporation or visit www.OHAUS.com

COMPLIANCE

Disposal

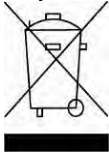

In conformance with the European Directive 2002/96 EC on Waste Electrical and Electronic Equipment (WEEE) this device may not be disposed of in domestic waste. This also applies to countries outside the EU, per their specific requirements.

Please dispose of this product in accordance with local regulations at the collecting point specified for electrical and electronic equipment. If you have any questions, please contact the responsible authority or the distributor from which you purchased this device.

Should this device be passed on to other parties (for private or professional use), the content of this regulation must also be related.

For disposal instructions in Europe, refer to
europe.ohaus.com/europe/en/home/support/weee.aspx

Thank you for your contribution to environmental protection.



OHAUS Corporation
7 Campus Drive
Parsippany, NJ 07054, USA
Tel: +1 973 377 9000
Fax: +1 973 944 7177

With offices worldwide
www.ohaus.com



* 3 0 0 6 4 4 7 8 *

P/N 30064478B © 2013 Ohaus Corporation, all rights reserved

Printed in China